

THIS COPY IS PROVIDED ON A RESTRICTED BASIS AND IS NOT TO BE USED IN ANY WAY DETRIMENTAL TO THE INTERESTS OF PANDUIT CORP.

| | |
|------------------|---------------------------------|
| PANDUIT PART NO. | WEIGHT |
| ECFX3 | .66 LB/100 PCS 302 g/100 PCS |

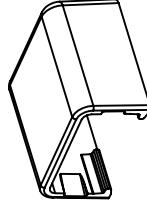

- NOTES:
- SEE CURRENT CATALOG FOR ADDITIONAL PART NUMBER SUFFIXES TO INDICATE COLOR AND OR PACKAGE QUANTITY.
 - THIS PRODUCT IS INTENDED TO BE USED WITH PANDUIT TYPE LDP3, LD3 AND LDS3 RACEWAY.
 - NOMINAL WALL THICKNESSES: .055(1.4).
 - DIMENSIONS IN PARENTHESIS ARE IN METRIC.

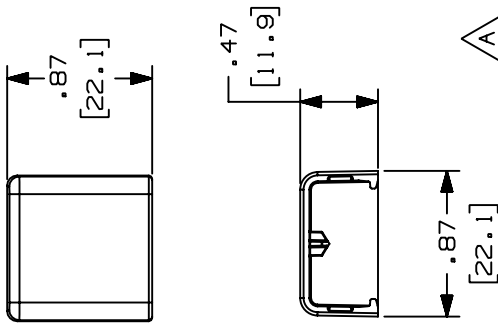

CAD FILENAME/LAYERS D35541CH_LLD_ECFX3_02.PRT

| | | | | | | | | |
|---|----------|---|------------------|---------------------------------|----------|------|------|-----|
| PANDUIT | | CORP. TINLEY PARK, ILLINOIS | | | | | | |
| END CAP FITTING COVER (ECFX3) | | CUSTOMER DRAWING | | | | | | |
| UNLESS OTHERWISE SPECIFIED, DIMENSIONAL TOLERANCES ARE: (.X) ± (.XXX) ±.015 (.4) (.XX) ±.03 (.8) ANGLES ± | | UNLESS OTHERWISE SPECIFIED, ALL DIMENSIONS ARE GIVEN IN INCHES, THIRD ANGLE PROJECTION. | | | | | | |
| DRAWN BY | JBA | MAT'L: | NONE | | | | | |
| DATE | 09-23-96 | ABS/PC | DWG NO. 35541-34 | | | | | |
| CHECKED BY | CEF | | SIZE A | | | | | |
| REV | DATE | BY | CHK | DESCRIPTION | ECN | CHK | CUST | SUP |
| 2 | 03-10-04 | JHEP | RGRO | B. REVISED CD3 FROM NOTE 2 | 35541-34 | RGRO | RGRO | |
| 1 | 05-18-99 | DW | H1W | A. REVISED DWG TO SHOW 2D VIEWS | 35541-34 | H1W | H1W | |
| R | 09-23-96 | JBA | CEF | RELEASED TO PRODUCTION | 35541-34 | CEF | CEF | |

+

+